

# Elements: 77496 / 70496 ZEUS

Over 300 leathers and fabrics to choose from. Your choice...

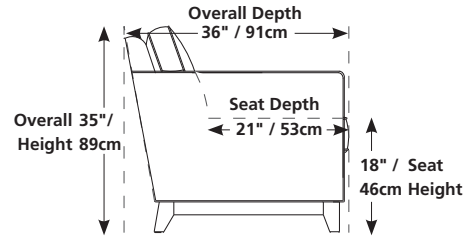

## Design • It • Yourself



23" / 58cm wide  
02 freestanding armless chair



23" x 23" x 17"  
58cm x 58cm x 43cm  
04 ottoman

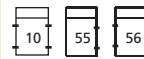

23" / 56cm wide  
10 armless chair  
55 LHF armless chair  
56 RHF armless chair



36" / 91cm wide  
11 corner square



32" x 63" x 35"  
81cm x 160cm x 89cm  
15 RHF chaise  
16 LHF chaise



54" x 42" x 35"  
137cm x 107cm x 89cm  
19 RHF bumper  
20 LHF bumper



37" x 23" x 17"  
94cm x 58cm x 43cm  
74 rectangular ottoman



23" / 58cm wide  
83 wedge seat 22°

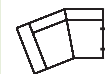

62" x 46" x 35"  
157cm x 117cm x 89cm  
97 LHF angled loveseat\*  
98 RHF angled loveseat



44" x 29" x 17"  
112cm x 74cm x 43cm  
64 angled storage ottoman



54" / 137cm wide  
07 LHF loveseat\*  
08 RHF loveseat



46" / 117cm wide  
09 corner curve



76" / 193cm wide  
12 LHF sofa\*  
13 RHF sofa



45" / 114cm wide  
14 armless loveseat



32" x 32" x 17"  
81cm x 81cm x 43cm  
23 angled ottoman

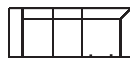

89" / 226cm wide  
39 LHF sofa split\*  
40 RHF sofa split



45" / 114cm wide  
85 wedge seat 45°



32" / 81cm wide  
88 LHF chair\*  
89 RHF chair

## MOST POPULAR CONFIGURATIONS

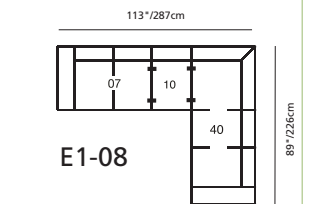
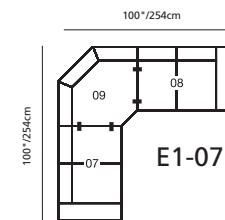
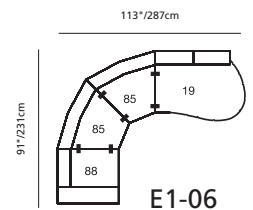
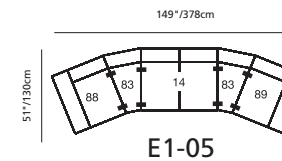
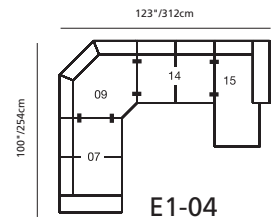
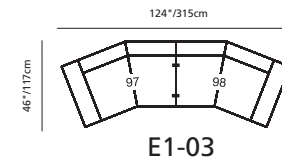
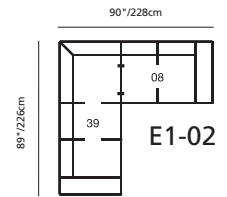
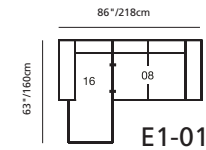

# Flexibility & CHOICE

Sit down. Stretch out. Relax.

Whether you are sipping a cappuccino all by yourself, or entertaining friends and family, **Elements** is the modular option for you! Beautiful, with clean lines and comfort to spare, this versatile collection allows you to custom design seating systems to suit your space and lifestyle.

These modular components have been engineered to connect together seamlessly, to allow for an infinite number of seating options. Here are just some of the possibilities you can create using the base elements. The results are stylish and multipurpose – providing you with the ultimate in functional solutions.

1

Choose your style

2

Choose your configuration

3

Choose your cover  
over 300 leathers & fabrics

4

Choose your leg finish color

OR

Visit [palliser.com](http://palliser.com)  
and click on the Room Builder box  
to create your own configuration  
to fit your home perfectly.